

Small · Concealed · Single and two stage · Two point and hand actuation lever

- Single or multi-point latch capability
- Compatible with wide array of actuators
- EN 45545-3 E60 compliant (standard version only)
- Integrated bumper version for anti-vibration feature

- Steel, zinc plated or 304 stainless steel, passivated

- Average ultimate load:
 - Steel: 4,600 N
 - Stainless steel: 4,000 N

- Striker bolts for standard version and integrated bumper version are different (sold separately)
- Cables and retainer clips (sold separately)

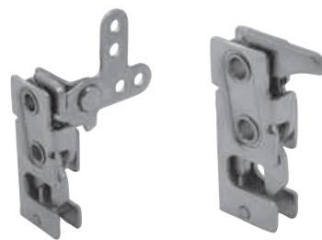

Technical drawing of the front view of the Trigger Housing (1). The drawing shows a rectangular housing with a trigger mechanism on the right side. Dimensions are given in inches and millimeters. Key features include a trigger, a cam, and mounting holes. A large grey arrow points to the right, indicating the direction of travel for the trigger.

Dimensions (inches in parentheses):

- Top width: 12.5 (.49)
- Top right width: 2 (.08)
- Left side width: 11 (.43)
- Left side width (lower section): 3.5 (.14)
- Right side height: 22.5 (.88)
- Right side height (lower section): 15.85 (.62)
- Bottom width: 28 (.1.1)
- Bottom width (lower section): 13.5 (.53)

Labels:

- Trigger
- Cam
- Housing
- 2 x Mounting holes (see table)

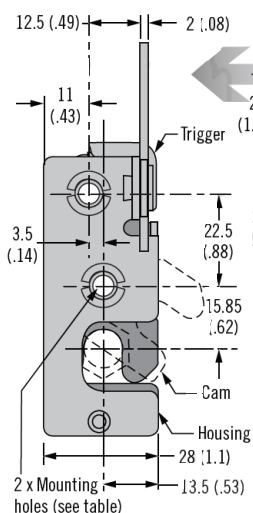

(dimensions same as standard version except as shown)

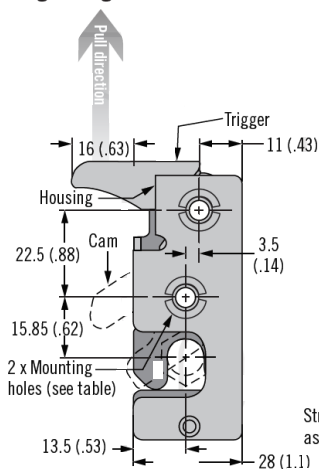
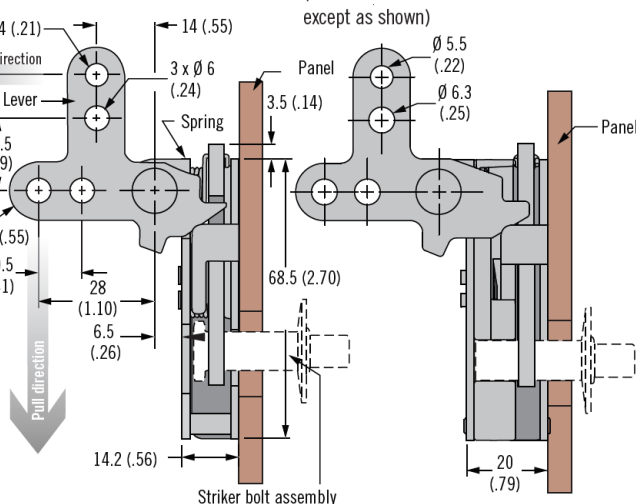

(dimensions same as standard version except as shown)

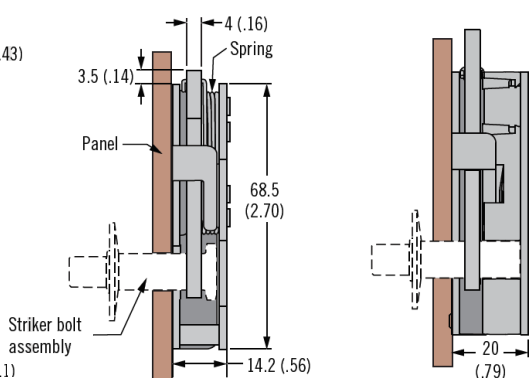

- 1 Single stage, right hand
- 2 Single stage, left hand
- 3 Two stage, right hand
- 4 Two stage, left hand

3 Two point
4 Hand actuation

R4 - 10 - S I - L O B - M

0 Ø7.2 (.283) thru
1 1/4-20 thread
2 M6 x 1 thread

B Base Style ←

1 Standard

5 Integrated bumper version

	Material
10	Steel
20	Stainless steel

southco®

We are proud to be Southco's authorized distributor of over 20 years

R4 Striker Bolt

Small - Installation

Features

- Striker bolt for R4-10 series rotary latch

Material

- Steel, zinc plated or stainless steel



Striker Bolt Assembly - Standard

(sold separately)

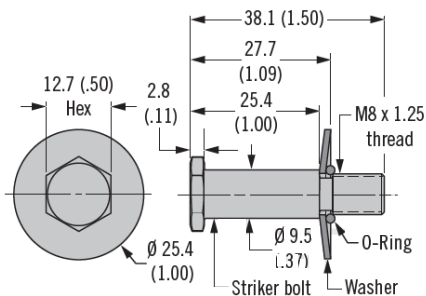

Striker Bolt Assembly - Integrated Bumper

(sold separately)

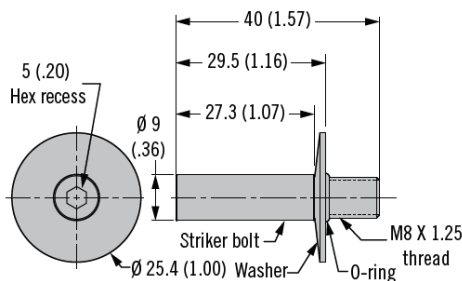

Striker 90° Mounting Bracket

Striker Bolt Part Number - Standard	
Part Number	Material
R4-90-121-10	Steel
R4-90-121-20	Stainless Steel
Striker Bolt Part Number - Integrated Bumper Version	
R4-90-124-10	Steel
R4-90-124-20	Stainless Steel

Striker Mounting Bracket Part Number
R4-0-50114

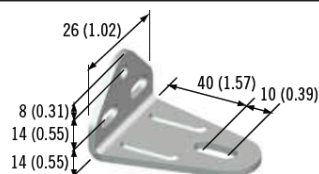

Operation

